

get started

INSTANT™ **VORTEX™ PLUS**
5.7L AIR FRYER
USER MANUAL

Instant™

Welcome

to your new Instant™ Vortex™ Plus!

This Instant™ Vortex™ Plus Air Fryer can help you cook delicious meals with less oil and less hassle. We hope you fall in love with Instant™ air frying and enjoy it in your kitchen for years to come!

Get started with your Vortex™ Plus air fryer!



Scan to Get Started!

To make your cooking experience with Instant™ as easy as possible, we have created 4 simple steps with how-to videos to guide you. Scan the QR code and follow the steps to become an Instant™ Chef in no time!

instantbrands.com.au/pages/getting-started



Download the **Instant Brands® Connect app** to access 1000's of recipe ideas.



Visit the **Instant Brands ANZ YouTube channel** for how-to videos and recipe inspiration.

⚠ WARNING

Before using your new Vortex™ Plus, read all instructions, including the Safety Instructions and the Warranty. Failure to follow the safeguards and instructions may result in personal injury and/or property damage.

CONTENTS

Important safeguards	2
What's in the box	7
Using your Air Fryer	8
Initial setup	9
Cooking	13
Smart programs	15
Cleaning	18
Troubleshooting	19
Error codes	20
Replacement parts	21
Learn more	22
Warranty	23
Notes	25



IMPORTANT SAFEGUARDS



⚠ WARNING

Safety Instructions

At Instant™, we want you to feel comfortable using our products. This Instant™ Air Fryer was designed with you and your safety in mind.

When using electrical appliances, basic safety precautions should always be followed to reduce the risk of fire, electric shock, personal injury/or property damage.

Read all instructions before using and only use this appliance as described in the in-box materials. Failure to follow these safeguards and instructions may result in personal injury and/or property damage, and can void your warranty.

Placement

- **DO** place the appliance on a countertop only. Always operate the appliance on a stable, non-combustible, level surface.
- **DO** make sure all parts are dry and free of food debris before use.
- **DO NOT** place the appliance on or close to a gas or electric burner, or oven.
- **DO NOT** use the appliance near water, an external heat source or flame.
- **DO NOT** use outdoors. Keep out of direct sunlight.
- **DO NOT** place on anything that may block the vents on the appliance.

General Use

- **DO** use the appliance's handles when opening the door/basket.
- **DO** use oven mitts when removing accessories.
- **DO** place hot accessories on a heat-resistant surface or cooking plate.
- **DO NOT** touch the appliance's hot surfaces, or any accessories during or immediately after cooking because they will be hot.
- **DO NOT** cover the basket, cooking tray or any part of the air fryer with foil. This will cause overheating of the air fryer.
- **DO NOT** move the appliance while it is in use.

⚠ WARNING

- **DO NOT** allow children or persons with reduced physical, sensory or mental capabilities to operate this appliance. Close supervision is necessary when any appliance is used by or near children and persons with reduced physical, sensory or mental capabilities. Children should not play with this appliance.
- **DO NOT** use the appliance for anything other than household use. It is not intended for commercial use.
- **DO NOT** leave the appliance unattended while in use.
- **DO NOT** use the appliance for more than 60 minutes in a 2-hour period.

Air Frying Cautions

When the air fryer is in operation, hot air is released through the air vents. Keep your hands and face away from the air vents and take extreme caution when removing hot accessories from the appliance. Failure to do so may result in personal injury and/or property damage.

While cooking, the internal temperature of the appliance reaches several hundred degrees. To avoid personal injury, never place unprotected hands inside the appliance until it has cooled to room temperature.

- **DO** use caution when using cooking containers made of materials other than metal or glass. Failure to do so may result in personal injury, fire and/or property damage.
- **DO** use extreme caution when removing the basket/cooking tray or disposing of hot cooking residue.
- **DO NOT** use a ceramic-coated or stoneware pot (such as CorningWare® stoneware) for air frying.
- **DO NOT** block the vents on the air fryer. Leave at least 5 in / 13 cm of space around the air fryer when in use.
- **DO NOT** place the appliance on a stove.
- **DO NOT** operate the appliance on or near combustible materials such as tablecloths and curtains.
- **DO NOT** cover the air vents while the air fryer is in operation. Doing so will prevent even cooking and may cause damage to the appliance.
- **DO NOT** use this appliance for deep frying foods.

⚠ WARNING

- **DO NOT** pour oil into the cooking container. Using excess cooking oil could cause fire and result in personal injury and/or property damage.
- **DO NOT** use pressureised, aerosol oil sprays, since they contain chemicals that can damage the non-stick finish of the cooking basket and tray. If needed, spray food lightly with oil with a high smoke point (such as refined avocado oil, safflower oil, refined sunflower oil, refined peanut oil, canola oil and refined coconut oil) from a non-aerosol, pump-style cooking spray before placing in the basket.
- Should the unit emit black smoke during use, press **Cancel** and unplug the appliance immediately. Wait for smoking to stop before opening the door/basket, allow to cool, then clean thoroughly. For further information refer to 'Troubleshooting'.

Overfill During Cooking

- **DO NOT** overfill the unit when air frying. Overfilling may cause food to contact the heating element, which may result in personal injury, fire, and/or property damage. For units with an air frying basket, do not fill more than 3/4 full. For units with a cooking tray, only fill with a single layer of food and do not stack food in layers. Best air frying results require air circulating through the food.
- **DO NOT** allow food to contact the heating element.

Accessories

- **DO** use only accessories or attachments authorised by Instant Brands. The use of parts, accessories or attachments not recommended by the manufacturer may cause a risk of electric shock or other personal injury, fire and/or property damage.
- **DO NOT** use the included accessories in a microwave, toaster oven, convection or conventional oven, or on a ceramic cooktop, electric coil, gas range or outdoor grill.

Care and Storage

- **DO** let the appliance cool to room temperature before cleaning or storage.
- **DO NOT** store any materials in the appliance when not in use.

⚠ WARNING

- **DO NOT** place any combustible materials in the appliance, such as paper, cardboard, plastic, Styrofoam or wood.
- **DO NOT** clean the appliance with metal scouring pads or steel wool. Pieces can break off and touch the electrical parts, causing a risk of shock, burns or other personal injury.

Power Cord

A short power-supply cord is used to reduce the hazards resulting from grabbing, entanglement or tripping. **WARNING:** Hot spilled food can cause serious burns.

- **DO** keep appliance and power cord away from children.
- **DO NOT** let the power cord hang over edges of tables or counters.
- **DO NOT** let the power cord touch hot surfaces or open flame, including a stovetop.
- **DO NOT** use below-counter power outlets.

This appliance has a 3-prong grounding plug. To reduce the risk of electric shock:

- **ONLY** plug the power cord into a grounded electrical outlet.
- **DO NOT** remove the grounding prong on the electrical plug.
- **DO NOT** use with extension cords, power converters or adapters, timer switches or separate remote-control systems.

Electrical Cautions

This appliance contains electrical components that are an electrical shock hazard. Failure to follow these instructions may result in electric shock and/or death.

To avoid electrical shock:

- To disconnect, select **Cancel**, then remove plug from power source. Always unplug when not in use, as well as before adding or removing parts or accessories, and before cleaning. To unplug, grasp the plug and pull from the outlet. **Never** pull from the power cord.
- **DO** regularly inspect the appliance and power cord for any signs of damage or fraying.
- **DO NOT** operate the appliance if the power cord or plug is damaged, or after the appliance malfunctions or is dropped or damaged in any manner. For assistance, contact Consumer Care by email at **support.au@instantbrands.com**

⚠ WARNING

- **DO NOT** attempt to dislodge food while the appliance is plugged into an electrical outlet, as this may cause electric shock, burns or other personal injury, and/or property damage.
- **DO NOT** attempt to repair, replace or modify components of the appliance, as this may cause electric shock or other personal injury, fire and/or property damage, and will void the warranty.
For assistance, contact Consumer Care by email at **support.au@instantbrands.com**
- **DO NOT** tamper with any of the safety mechanisms, as this may result in personal injury and/or property damage.
- **DO NOT** immerse the power cord, plug or the appliance in water or other liquid.
- **DO NOT** clean the appliance by rinsing it under a faucet.
- **DO NOT** use the appliance in electrical systems other than 220-240V~, 50-60Hz for Australia and New Zealand.

SAVE THESE INSTRUCTIONS

⚠ WARNING

Failure to follow safety instructions may result in personal injury and/or property damage and may void your warranty.

WHAT'S IN THE BOX

Instant™ Vortex™ Plus Air Fryer

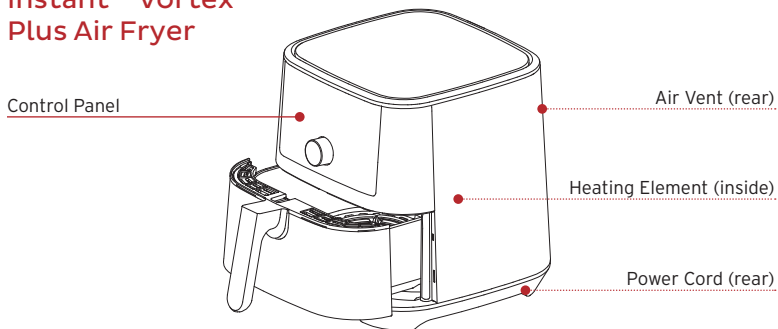

Parts + accessories

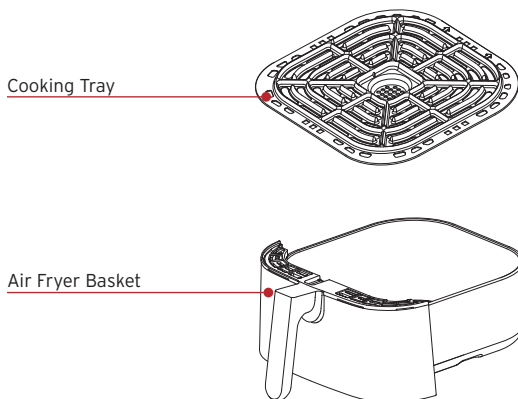

Illustrations are for reference only and may differ from the actual product.

Remember to recycle!

We designed this packaging with sustainability in mind. Please recycle everything that can be recycled where you live.

USING YOUR VORTEX PLUS

Control panel

We've designed the control panel to be simple to use and easy to read.

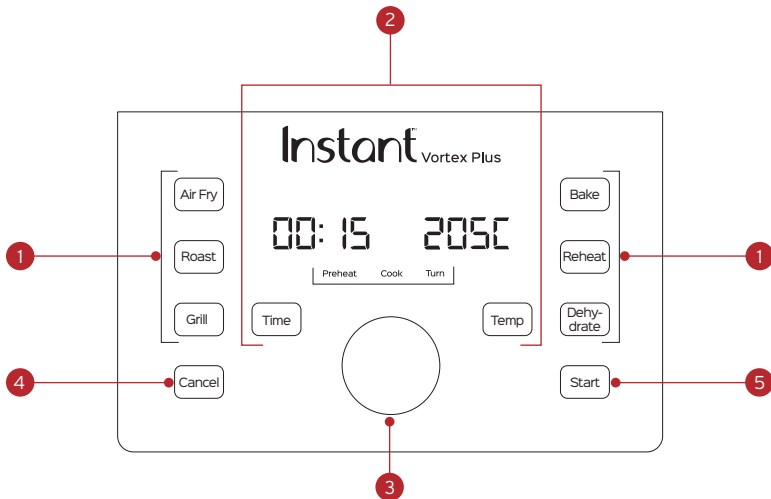

1. Smart Programs
 - Air Fry
 - Roast
 - Grill
 - Bake
 - Reheat
 - Dehydrate
2. Time/Temperature
 - Cooking time
 - Cooking temperature
 - Messages
3. Control Dial
 - Used to select time and temperature
4. Cancel
5. Start

INITIAL SETUP

Unpack

1. Remove your new Vortex™ Plus from the box.
2. Remove all the packaging material from in and around the air fryer.
3. Make sure to remove all the accessories from inside the cooking chamber.
4. Don't remove the safety warning stickers or the rating label from the air fryer.

Clean before use

1. Wipe the interior with a damp cloth. Use a clean, soft cloth to dry.
2. Wash the accessories with hot water and dish soap. Rinse with warm, clear water and use a soft cloth to dry.

Placement

1. Place your Vortex™ Plus on a stable, level surface, away from combustible material and external heat sources. Do not place your Vortex™ Plus on top of another appliance.
2. Make sure to leave at least 5 in / 13 cm of space above and around all sides of the appliance to allow for sufficient air flow.

Test run

Before using your new Instant™ Vortex™ Plus for the first time, you must perform a test run to ensure everything is working correctly.

To perform a test run:

1. Ensure the Vortex™ Plus is plugged into an electrical outlet.
2. Insert the cooking basket, but **DO NOT** add food.
When the air frying basket is inserted securely, the front of the basket is flush with the front of the air fryer.
3. Select the **Air Fry** program.
4. Select the default cooking temperature (400°F / 205°C).
5. Select the default cooking time (15 minutes).
6. When the display shows **Add Food**, just remove and reinsert the cooking basket (**DO NOT** add any food).
7. When the display shows **Turn Food**, just remove and wait 10 seconds for the program to resume.
8. The air fryer will beep, letting you know the cooking program is done.
9. Let the unit cool.

Now you're ready to cook a meal in your Instant™ Vortex™ Plus!

Turning sound On/Off

- While in Standby mode, press and hold **Time** and **Temp** for 5 seconds.

Audible safety alerts (beeps) cannot be turned off.

Choosing temperature unit

Choose which cooking temperature unit you would like to use, Fahrenheit or Celsius.

- While in Standby mode, press and hold **Temp** for 5 seconds, until display shows either °F or °C.

Save custom settings

You can set and save custom time and temperature settings for any of the six Smart Programs.

Time

10. Select the Smart Program you want to change.
11. Press **Time** button and use the Control Dial to change the temperature.
12. Press **Start** to save your changes.

Temperature

1. Select the Smart Program you want to change.
2. Press **Temperature** button and use the Control Dial to change the temperature.
3. Press **Start** to save your changes.

The next time you use that Smart Program the new temperature or time is used. Adjustments made after cooking begins are not saved.

Reset Smart Programs to original settings

Reset individual Smart Programs

1. With the air fryer in Standby mode, press and hold one of the Smart Program buttons until the air fryer returns to Standby.

The Smart Program's cooking time and temperature are restored to the factory default setting.

Reset all Smart Programs

2. With the air fryer in Standby mode, press and hold the **Control Dial** until the air fryer beeps.

All Smart Program cooking times and temperatures are restored to the factory default setting.

Cancel active cooking program

You can cancel any cooking program at any time.

- While in Standby, Preheating or active cooking program, press **Cancel**. Depending on the internal temperature of the unit, the fan may keep running to cool the air fryer.

COOKING

The Instant™ Vortex™ Plus uses rapid air circulation to crisp or cook food, giving your meals all the rich, crispy flavour of deep frying, with little to no oil.

⚠ WARNING

HOT SURFACES

The air fryer chamber will be hot during and after cooking. Always exercise extreme caution when removing food from the hot air frying basket and cooking chamber. Touching hot surfaces may result in personal injury, and/or property damage.

MUST ALLOW AIR FLOW

To prevent personal injury, **DO NOT** block air intake or air vents.

Prep

Cut, chop, season, marinate or batter your ingredients according to your recipe.

Cook

1. Place your food into the air frying basket, according to your recipe.
2. Insert the air frying basket into the air fryer.

When the air frying basket is inserted securely, the front of the basket is flush with the front of the air fryer.

When using the Reheat program, you should add food at this point.

3. Press one of the Smart Program (Air Fry, Roast, etc.) buttons on the control panel.
4. Press **Temp** and **Time** to adjust the temperature and cooking time.
5. Press **Start** to begin. The display shows **Preheating** to indicate that the cooking program has started.

See page 10 to adjust Smart Program settings.

Add food

1. When the air fryer reaches the target temperature, the display shows **Add Food**.

When using the Reheat program, the air fryer does not prompt you to add food.

2. Remove the basket, and carefully insert your food into the basket.
3. Reinsert the air frying basket into the air fryer and the cooking countdown timer starts.

Turn

1. Part way through the cooking cycle the display shows Turn Food.

If you do not remove the basket after Turn Food displays, cooking will proceed after 10 seconds.

2. Remove the air fryer basket from the air fryer and carefully turn, flip, or rotate your food.
3. Insert the air frying basket into the air fryer. Cooking continues.

Finish

- When the Smart Program completes, the lid beeps, and the display shows **End**.

The air fryer beeps after 5 minutes, 20 minutes, and 60 minutes to remind you that cooking has completed.

SMART PROGRAMS

Air Fry

You can air fry foods like fries, cauliflower bites, wings, nuggets and more.

Setting	Default	Minimum	Maximum
Temperature	385°F / 196°C	180°F / 82°C	400°F / 205°C
Cooking Time	15 minutes (00:15)	1 minute (00:01)	1 hour (01:00)

To air fry

- Follow the basic instructions for Cooking.
- Select “Air Fry” as the Smart Program.

Roast

You can roast foods like beef, lamb, pork, poultry, vegetables and potatoes, for a deliciously tender inside and browned outside.

Setting	Default	Minimum	Maximum
Temperature	380°F / 193°C	180°F / 82°C	400°F / 205°C
Cooking Time	18 minutes (00:18)	1 minute (00:01)	1 hour (01:00)

To roast

- Follow the basic instructions for Cooking.
- Select “Roast” as the Smart Program.

Bake

You can bake foods like breads, cakes, chicken breasts or potatoes, using your Instant™ Air Fryer instead of heating up your regular oven.

Setting	Default	Minimum	Maximum
Temperature	365°F / 185°C	180°F / 82°C	400°F / 205°C
Cooking Time	30 minutes (00:30)	1 minute (00:01)	1 hour (01:00)

What to cook in

- For soft foods (like bread dough), liquid-based foods (like cake batter) and foods that may drip during cooking (like chicken breasts), use a metal or glass baking dish. Leave approximately 1 in/ 2.5 cm of space around all sides of the baking dish to allow heat to circulate evenly.
- For solid foods (like potatoes), use the cooking tray.

To bake

- Follow the basic instructions for Cooking.
- Select “Bake” as the Smart Program.
- There is no need to turn the food partway through cooking.
Leave approximately 1 in / 2.5 cm of space around all sides of the baking dish to allow heat to circulate evenly.

Grill

Grilling cooks using direct top-down heating, perfect for melting cheese on French onion soup, and nachos.

Setting	Default	Minimum	Maximum
Temperature	400°F / 205°C	400°F / 205°C	400°F / 205°C
Cooking Time	6 minutes (00:06)	1 minute (00:01)	40 minutes (00:40)

To grill

- Follow the basic instructions for Cooking.
- Select “Grill” as the Smart Program.
- There is no need to turn the food partway through cooking.

Dehydrate

Dehydrating uses low heat over a long period of time to safely dry out food items, like dried fruit, jerky and dried veggies.

Setting	Default	Minimum	Maximum
Temperature	130°F / 54°C	95°F / 35°C	175°F / 79°C
Cooking Time	8 hours (08:00)	1 hour (01:00)	72 hours (72:00)

To dehydrate

- Follow the basic instructions for Cooking.
- Select “Dehydrate” as the Smart Program.
- There is no need to turn the food partway through cooking.

Reheat

Bring the crisp and crunch back to leftover fries, pizza and stale bread, in just a few minutes.

Setting	Default	Minimum	Maximum
Temperature	280°F / 138°C	120°F / 49°C	360°F / 182°C
Cooking Time	10 minutes (00:10)	1 minute (00:01)	1 hour (01:00)

To reheat

- Follow the basic instructions for Cooking.
- Select “Reheat” as the Smart Program.

Once this Smart Cooking function starts, the display will show the target temperature and cooking time immediately, there's no preheating time.

CLEANING

Clean your Instant™ Vortex™ Plus after each use. Always unplug the unit and let all parts cool to room temperature before cleaning. Before use or storing, make sure all surfaces are dry.

⚠ WARNING

DO NOT immerse power cord, plug or the appliance in water or other liquid, which may result in electric shock.

Part	Cleaning instructions
Cooking tray	<ul style="list-style-type: none">• Dishwasher safe.*• The cooking tray has a non-stick coating. Avoid using abrasive cleaners or metal utensils when cleaning.
Removable air fryer basket	<ul style="list-style-type: none">• Clean with a damp cloth and mild dish soap.• Allow the basket to air dry completely before reinstalling, otherwise the glass may experience clouding.
Cooking chamber	<ul style="list-style-type: none">• Clean with a damp cloth and mild dish soap.• Always check the heating coil and cooking chamber walls for oil spatter and food debris, and clean as needed.• Ensure the heating coil is dry before turning on the air fryer.• To remove baked-on grease and food residue from the cooking chamber, spray with a mixture of baking soda and vinegar and wipe clean with damp cloth. For stubborn stains, allow the mixture to sit on the affected area for several minutes before scrubbing clean.
Power cord	<ul style="list-style-type: none">• Clean with a soft, damp cloth or sponge. Wipe dry.

**Some discolouration may occur after machine washing, but this will not affect the air fryer's safety or performance.*

TROUBLESHOOTING

Problem	Cause	Solution
Air fryer will not turn on	The appliance is not properly plugged in.	<ul style="list-style-type: none"> Make sure the power cord is plugged into the outlet firmly.
	Outlet is not powered.	<ul style="list-style-type: none"> Plug another appliance into the same outlet to test the circuit.
	The air fryer basket is open.	<ul style="list-style-type: none"> Make sure the door is fully closed.
Black smoke is coming from the air fryer	Using an oil with a low smoke point.	<ul style="list-style-type: none"> Cancel the Smart Program, unplug the air fryer and allow it to cool to room temperature. Choose a neutral oil with a high smoke point, such as Canola, Avocado, Soybean, Safflower, or Rice Bran.
	Food residue on the heating coil, in the cooking chamber or on the accessories.	<ul style="list-style-type: none"> Cancel the Smart Program, unplug the air fryer and allow it to cool to room temperature. Remove all accessories from the cooking chamber and clean the cooking chamber and all accessories thoroughly.
	Appliance malfunction.	<ul style="list-style-type: none"> Contact Consumer Care.
White smoke is coming from the air fryer	Cooking foods with a high fat content, such as bacon, sausage, and hamburger.	<ul style="list-style-type: none"> Avoid air frying foods with a high fat content. Check the cooking chamber for excess oil and/or fat and carefully remove as needed before air frying.
	Water is vaporising, producing thick steam.	<ul style="list-style-type: none"> Pat dry moist food ingredients before air frying. Do not add water or other liquid to the cooking chamber when air frying.
	Seasoning on food has blown into element	<ul style="list-style-type: none"> Be mindful when seasoning food. Spray vegetables and meats with oil before seasoning to help the seasoning stick.



ERROR CODES

If the control panel displays an error code from this list, there is an issue with the Vortex™ Plus. Here are the actions you should take to fix the problem.

Problem	Cause	Solution
E1	Open circuit.	• Contact Consumer Care.
E2	Temperature sensor short circuit.	• Contact Consumer Care.

REPLACEMENT PARTS

We offer genuine replacement parts for your Vortex™ Plus Air Fryer, if you need visit www.instantbrands.com.au to order.

	Part	Part number
	Cooking Tray	210-0052-01
	Basket	210-0046-01

Replacement parts sold separately and subject to availability.

LEARN MORE

There's a whole world of Instant™ information and help just waiting for you. Here are some of the most helpful resources.

Register your product

<https://www.instantpot.com.au/pages/product-registration>

Contact Consumer Care

[w] www.instantpot.com.au

[e] sales@cdbgoldair.com

[ph] 0393 655 100



Download the Instant Brands Connect App

- Recipes
- New User Tips
- Getting Started Videos



Join the community

  @Instant.anz

  @Instantanz

Product specifications

Model	Volume	Wattage	Power
Vortex Plus 6	6 Quarts 5.7 Litres	1450 - 1700 W	220-240V~, 50-60Hz

WARRANTY



one (1) year limited replacement warranty statement.

If your product becomes defective due to faulty material or workmanship within a period of 1 year from the date of purchase, we warrant to do the following:

For New Zealand Consumers: We will replace the product with a new product, free of charge, or repair the product at our cost, at our discretion.

For Australian Consumers: Our goods come with guarantees that cannot be excluded under the Australian Consumer Law. You are entitled to a replacement or refund for a major failure and for compensation for any other reasonably foreseeable loss or damage. You are also entitled to have the goods repaired or replaced if the goods fail to be of acceptable quality and the failure does not amount to a major failure.

YOUR WARRANTY IS SUBJECT TO THE FOLLOWING CONDITIONS:

- **DO NOT** operate the appliance with a damaged plug or cord, or if the unit has been dropped, damaged or dropped in water. To avoid the risk of electric shock, do not disassemble or attempt to repair the appliance on your own. If the supply cord is damaged, it must be replaced by a qualified electrician in order to avoid a hazard. Incorrect reassembly or repair can cause a risk of electric shock or injury to persons when the appliance is used.
- The item has not been misused, abused, neglected, altered, modified or repaired by anyone.
- The item has been subjected to fair wear and tear.
- The item has not been used for trade, professional or hire purposes.
- The item has not sustained damage through foreign objects, substances or accident.

WARRANTY

YOUR WARRANTY DOES NOT COVER:

- Components that are subject to natural wear and tear caused by normal use in accordance with operating instructions.
- Unauthorised/improper maintenance/handling or overload is excluded from this warranty.
- For guarantee claims, you will need to submit a proof of purchase in the form of a valid receipt that displays date and place of purchase.

This warranty does not replace but is in addition to your statutory rights.

This warranty does not apply to accessories supplied with the item.

This warranty applies only to the original purchaser and may not be transferred.

Replacement items will be covered by the limited warranty for the balance of the warranty period from the date of the original purchase.

PLEASE NOTE: Only the defective product or parts returned to place of purchase will be replaced under this warranty.

NOTES

This image shows a single sheet of white paper with horizontal ruling lines. The lines are evenly spaced and run across the width of the page. There are no margins, text, or other markings on the paper.

NOTES

[illegible]

NOTES

This image shows a blank sheet of white paper with horizontal ruling lines. The lines are evenly spaced and run across the width of the page. There are no margins, text, or other markings on the paper.

instantpot.com.au

instantpot.co.nz